

**Rent our space, support art in Portland.**



Photo by **Roberto Rodriguez Photography** [www.rodriquezphotos.com](http://www.rodriquezphotos.com) @rrphotos\_pdx

Oregon Center for Contemporary Arts's facility is an inspiring and creative environment that adapts to a variety of sizes and needs.

As a 501(c)3 nonprofit organization that relies on donations and grants, your rental fee allows Oregon Contemporary to provide a professional platform in which curators and artists can realize their best work.

Top 20 of **AirBnB's** Arts and Culture  
recommendations for Portland

*Exhibition and performance space, artists' hub, innovative arts programmer –since its inception 15 years ago, Oregon Contemporary (formerly Disjecta) has blossomed from a scrappy, word-of-mouth gem into a beloved Portland cultural institution.*

**- Portland Monthly**

Information - Dustin Williams | [events@oregoncontemporary.org](mailto:events@oregoncontemporary.org)

## Events at Oregon Contemporary

Conveniently located at the Kenton MAX station on Trimet's yellow line, we welcome private and corporate parties, community meetings, photo or video shoots, weddings, holiday celebrations, concerts, film screenings, and more.

Soaring ceilings, dramatic lighting, and a food cart friendly outdoor space further enhance what is already a flowing and well-designed space for your gathering.



Photo by [Andrea Lonas](#)

### Amenities

- \* On-site event manager
- \* Kitchenette with full-size fridge/freezer and sink
- \* Bar with beer, wine, and non-alcoholic beverages
- \* Access to green room
- \* Outdoor courtyard/green space with stage that can accommodate food trucks
- \* Wireless internet
- \* Adjustable gallery track lighting
- \* ADA accessibility

### Equipment available (fees apply):

- |                            |                                   |
|----------------------------|-----------------------------------|
| (6) 6' banquet tables      | (1) white board                   |
| (6) 8' banquet tables      | (1) metal alter                   |
| (5) 60" round tables       | (many) flower vases               |
| (130) black folding chairs | (4) Optoma Short Throw Projectors |
| (8) modular stage pieces   | (2) Optoma EH500 Projectors       |

## Our Community + Location

### The Center

Oregon Center for Contemporary Art (formerly Disjecta Contemporary Art Center) serves Portland and the Pacific Northwest with risk-taking, dynamic programming from regional and national artists, offered free to the public. By hosting your event at Oregon Contemporary, you not only support these efforts but also join a vibrant community of Portlanders devoted to making extraordinary things throughout our 10,000-square-foot building, outdoor locations, and online.

### Kenton Neighborhood

Oregon Contemporary is located in the historic and diverse North Portland neighborhood of Kenton, providing a cultural center for the community. The iconic statue of Paul Bunyan is next door and North Denver Avenue is home to many restaurants and shops.

### Location

Oregon Contemporary is located 7 miles from Portland International Airport and is directly across from the Yellow Line MAX light rail at the Kenton/ N Denver Avenue stop.

### Parking

Onsite and street parking is available.

### Nearby Accommodations

The newly renovated boutique Kenton Hotel is located next door. **Accessibility** Platform and Galleries 1 and 2 are ADA accessible, and there is an ADA restroom located in the green room.

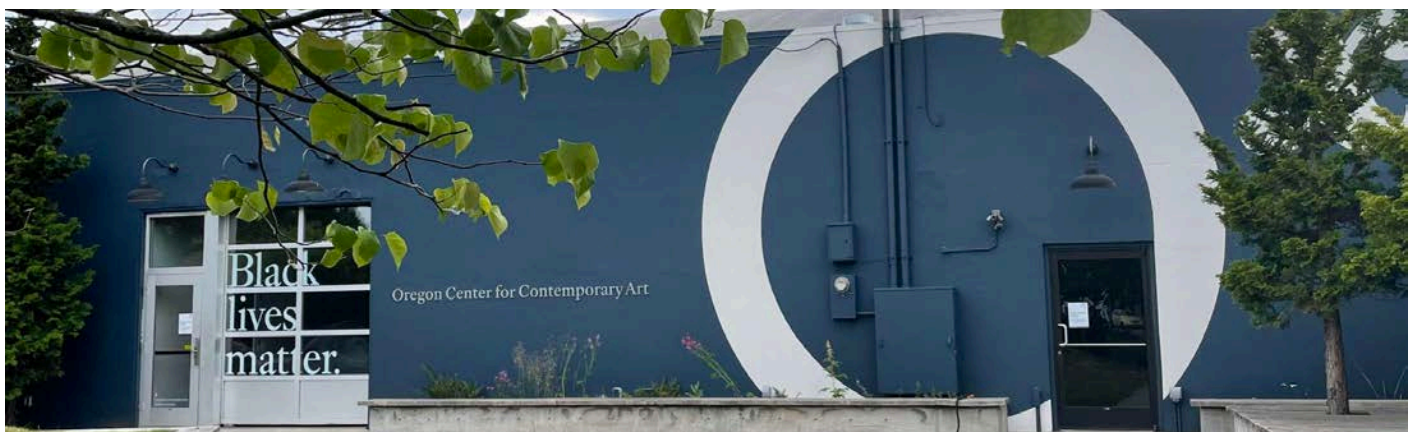

## **Event Spaces at Oregon Contemporary**

### **Disjecta Studio**

The newly named Disjecta Studio (formerly Platform) is a versatile 1,600 square foot space that offers high ceilings, tons of natural light, adjustable gallery track lighting, excellent acoustics, expansive white walls that function perfectly as projection screens, and a private entrance (ADA accessibility is through main gallery space).

Available Saturdays.

Rental rate: \$1,000 per day. *Please inquire about special rates for artists, nonprofits and multi-day events. Rental fee is based on a 10-hour block of time.*

## Gallery 1 & Gallery 2

Galleries 1 & 2 are blank slates for large-scale events and boast polished concrete floors, expansive white walls and flexible lighting.

Availability: based on Oregon Contemporary's exhibition schedule. During your requested time frame it is likely artwork will be on view in the gallery. Please contact us for availability and details, and please understand that limitations may apply.

Rental rate: \$1,000 per day for Gallery 2. \$3,000 per day for Gallery 1. \$4,000 for both Gallery spaces. Plus \$35/hour required site manager fee. Based on availability. *Please inquire about special rates for artists, nonprofits and multi-day events. Rental fee is based on a 10-hour block of time.*



## Outdoor space

The courtyard at Oregon Contemporary is an outdoor green space that flows seamlessly into the indoor gallery spaces via a roll-up glass garage door. The space has a built-in wooden stage and a tiered grassy area that can function as seating. It can accommodate food trucks and is ADA accessible.

Rental Rate: The courtyard is included when renting Platform and Galleries 1 and 2. For just the courtyard: \$100/hour, 5-hour minimum. Plus required \$35/hour site manager fee.



Photo by [Roberto Rodriguez Photography](http://www.rodriquezphotos.com) [www.rodriquezphotos.com](http://www.rodriquezphotos.com) @rrphotos\_pdx

# Layout



**Platform Dimensions + Power**

*Electrical outlet locations indicated in orange. ADA ramp indicated in light blue.*

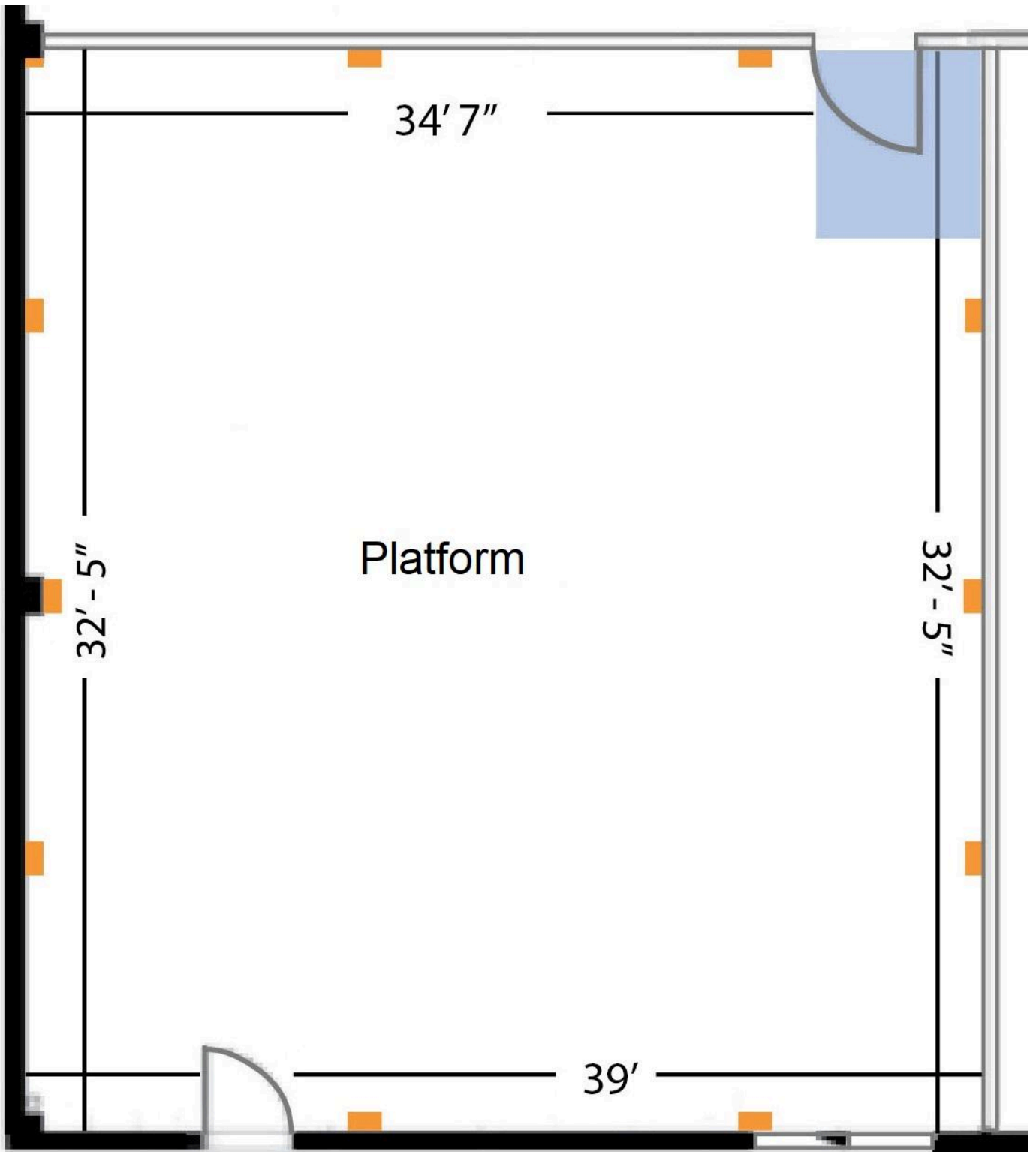



## Gallery 1 & Gallery 2 Dimensions + Power

Wall height approximately 12'. Ceiling height variable (from 12' to 25'). Electrical outlets at 12' on rafters throughout gallery indicated by pink lines.

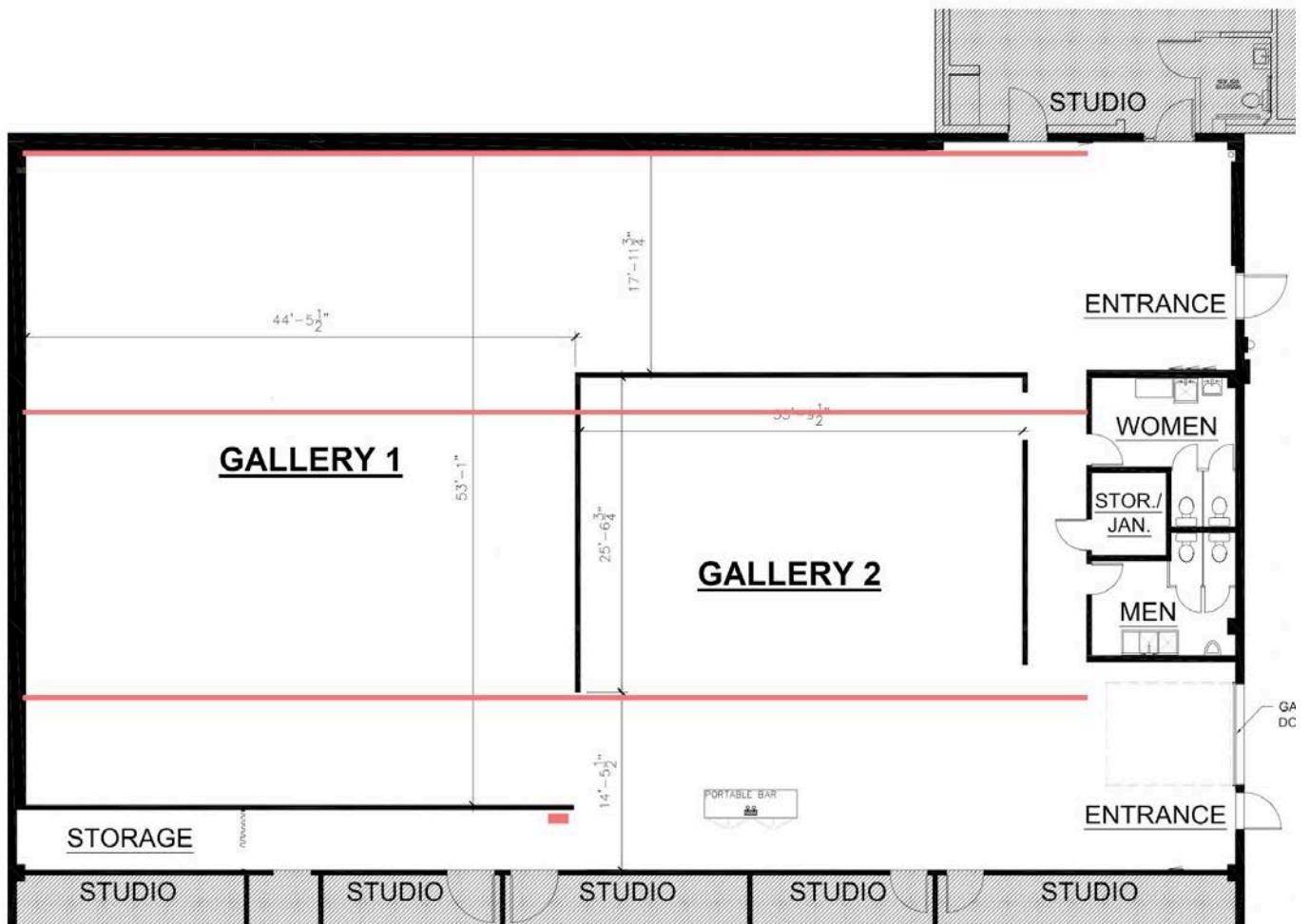

## **Policies**

### **Payment + Deposits**

A major credit card is required to be on file for all events. Payment can be made with a corporate check or money order, but all checks must clear one week before the event date. To secure the space, Oregon Contemporary requires a signed contract, a \$250 security deposit, and a deposit of 50% of the rental fee. The remaining rental balance is due within 14 days of the event date. Security deposit is fully refundable, provided all decor and trash are removed at the conclusion of the event. There is a \$35 per hour site manager fee required for all events.

### **Cancellations**

The 50% deposit is refundable, less a \$150 administrative fee, if cancellation occurs before 90 days of Oregon Contemporary's receipt of signed contract. In the event of Renter cancellation within 30 days of event date, Renter is responsible for 80% of full rental amount minus deposit. In the event of Renter cancellation within 60 days of event date, Renter is responsible for 60% of full rental amount minus deposit. In the event of Renter cancellation within 14 days of event date, Renter is responsible for full rental amount.

### **Rental Time**

Platform, Gallery 1 and Gallery 2 rentals are typically charged as a 10-hour block of time. This includes setup time for all vendors, event time and time for breakdown and load-out. All rented equipment owned by Oregon Contemporary will be set prior to the start time stated in your rental contract, provided Oregon Contemporary receives this information one week prior to the event date. Any activities (including deliveries) that fall outside the contracted rental time or Oregon Contemporary's office hours will incur an hourly charge specified in the rental contract.

### **Insurance**

A certificate of liability insurance providing \$1,000,000 per occurrence and naming Oregon Center for Contemporary Art as additionally insured is required for events with over 80 guests. A one day special event policy can be pulled from [www.eventhelper.com](http://www.eventhelper.com) (cost varies but is around \$100 for events with 100 guests). See event contract for specific requirements.

### **Bar Service + Liquor Liability**

Oregon Contemporary has a bar with beer, wine, cider, kombucha, coffee and flavored sparkling water. A beverage price sheet is available upon request. Beverage service can be hosted, no-host/cash bar, or partially hosted. OLCC-certified bartender(s) will be hired by Oregon Contemporary for an additional fee. Bar buyouts are available; client must use an OLCC-certified

catering partner. Liquor service incurs additional OLCC permits and fees.

### **Permits**

Client is responsible for researching and obtaining any and all permits required by the City of Portland. These permits are not limited to, but may include OLCC licenses, tent permits, sound variances or fire marshal permits. Client is solely responsible for obtaining proper permitting and will reimburse Oregon Contemporary for any fees incurred due to client negligence.

### **Decor Guidelines**

Flameless (battery-operated) candles only. No glitter or confetti is allowed anywhere on premises. Artists or clients wishing to hang or affix artwork or other materials to gallery walls must submit installation plan and obtain prior approval one week in advance of the event date. Additional fees may apply if wall patching or painting is required. No stiletto heels are permitted in Disjecta space. Security deposit will be forfeited if your decor does not comply with these guidelines, or is not completely removed by the end of your event time window.

### **Trash**

There are dumpsters on-site. All trash and recycling (including food and bathroom waste) must be removed from the building at the conclusion of event and disposed of in dumpsters.

### **Preferred Vendors**

Oregon Contemporary has an open vendor policy. Contact Dustin for recommendations on caterers, food trucks, A/V, lighting, rental companies and event planners who would make your event a success.









Photo by **Roberto Rodriguez Photography** [www.rodriquezphotos.com](http://www.rodriquezphotos.com) @rrphotos\_pdx